



LIFTINGITALIA S.r.l.

Via Caduti del Lavoro, 16 - 43058 Bogolese, Sorbolo (PR) - Italy
Phone +39 0521.695311 - Fax +39 0521.695313



**AREALIFT
LIFTINGITALIA**

EasyPlat

Electric belt driven low rise platform lift

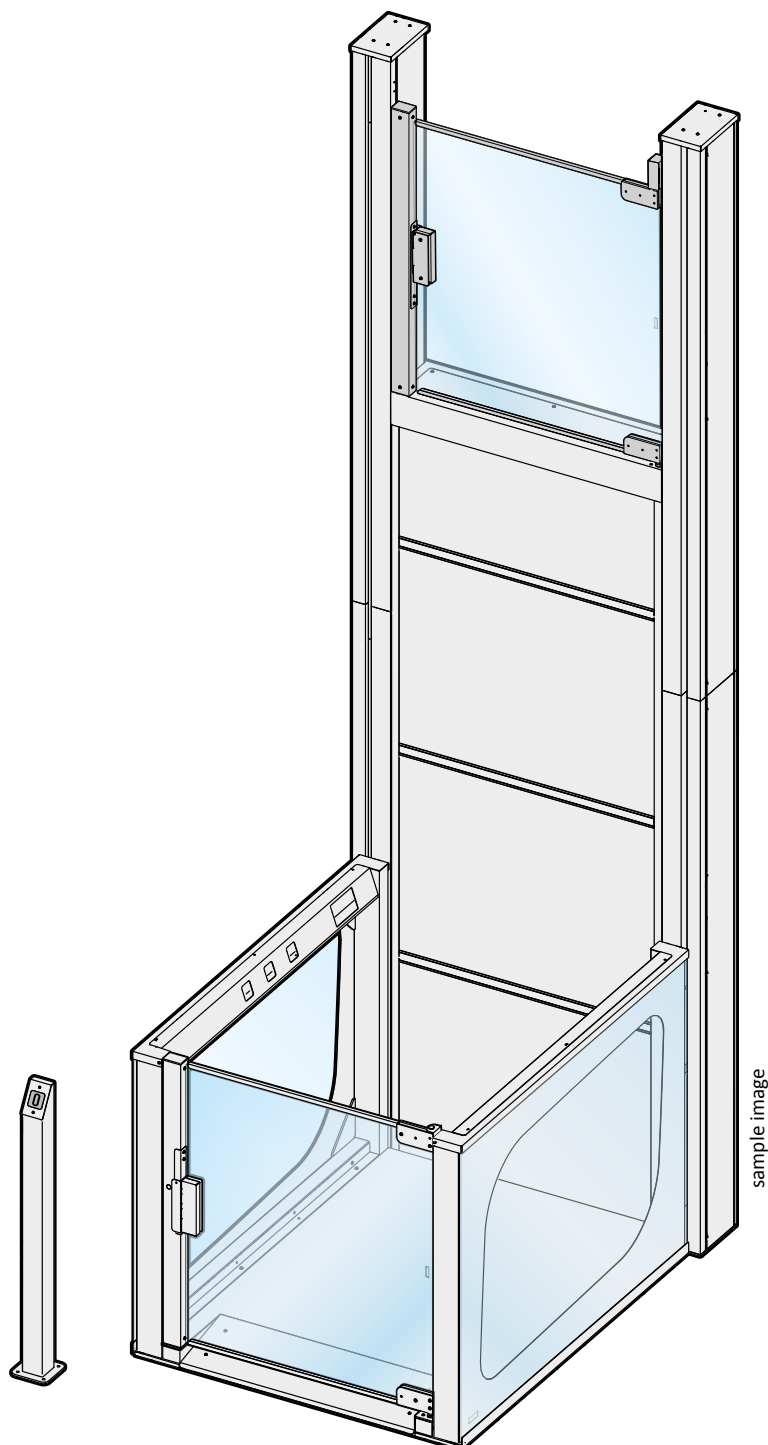

USER MANUAL



SUMMARY SHEET

DATE:
MACHINE NUMBER:
ADDRESS:
INSTALLER:
MAINTENANCE COMPANY:
TESTING NOTIFIED BODY:

DEALER / INSTALLER STAMP

--

1.1	Update p. 13	25.05.2022
1	Pag. 9 insertion	17.02.2021
0	First edition	10.06.2020
Rev.	Description	Date

TABLE OF CONTENT

	PURPOSE OF THE MANUAL	3
	INFORMATION FOR LIFTING PLATFORM OWNER	4
1	PRODUCT DESCRIPTION	6
2	LIFT EMPLOYMENT AND OPERATION	7
2.1	NORMAL OPERATION MODE	7
2.2	LANDING OPERATION PANELS	7
2.3	PLATFORM OPERATION PANEL	8
2.4	OPERATION FROM LANDING OPERATION PANELS	9
2.5	OPERATION FROM CAR OPERATING PANEL (COP)	9
2.6	PRESSURE SENSITIVE PROTECTIVE DEVICE - PLATFORM SAFETY UNDERPAN	9
2.7	ENABLE / DISABLE THE PLATFORM	10
2.8	REMOTE COMMANDS	10
2.9	ACOUSTIC SIGNALS FOR THE USER	10
2.7	POWER OUTAGE EMERGENCY OPERATION	11
2.8	EMERGENCY STOP	11
2.9	LIFT OVERLOAD	11
2.10	LIFT FAILURE	11
2.11	TELEPHONE ASSISTANCE (recommended option)	12
2.12	SWITCHING OFF THE LIFT	12
2.13	MAINTENANCE AND CLEANING	12
3	SAFETY SIMBOLS	13



PURPOSE OF THE MANUAL

The purpose of this manual is to provide correct information on the installation and correct use of the product, in order to contribute to personal safety and to the proper functioning of the system. Keep the manual for the entire life of the product. In the event of a change of ownership, the manual must be provided to the new user as an integral part of the product.

NOTICE

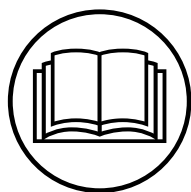

READ THIS MANUAL CAREFULLY before installing and using the product. This product must be installed and put into operation according to the provisions and regulations in force. Improper installation or improper use of the product can cause damage to people and property, as well as cause the warranty to lapse.

FOLLOW THE SUGGESTIONS AND RECOMMENDATIONS TO OPERATE IN SAFETY.

Any unauthorised modification can compromise the safety of the system, as well as the correct operation and the life of the machine. If you have any doubts regarding the correct understanding of the information and contents contained in this manual, contact LIFTING ITALIA S.r.l. immediately.

QUALIFIED PERSONNEL: The product covered by this documentation can only be installed by qualified personnel, in compliance with the attached technical documentation, above all in compliance with the safety warnings and the precautions contained therein.

Keep the technical and safety documentation near the lift system.



PERSONAL SECURITY AND RISK RECOGNITION

This manual contains safety rules that must be observed to safeguard personal safety and to prevent damage to the property. The indications to be followed to guarantee personal safety are highlighted by a triangle symbol while those to avoid material damage are not preceded by the triangle. The hazard warnings are shown as follows and indicate the different levels of risk in descending order.

RISK SYMBOLOGY AND PHRASES

RISK CLASSIFICATION AND RELATIVE GRAVITY OF DAMAGE		
DANGER	The symbol indicates that the failure to comply with appropriate safety measures causes death or serious physical injury.	RISK LEVEL
WARNING	The symbol indicates that the failure to observe the corresponding safety measures can cause death or serious personal injury.	
CAUTION	The symbol indicates that failure to observe the relevant safety measures can cause minor or moderate personal injury or damage to the device.	
NOTICE	It is not a symbol of security. It indicates that the failure to comply with relevant safety measures can result in property damage.	
INFORMATION	It is not a symbol of security. It indicates important information.	

If there are multiple levels of risk, the danger warning always indicates the highest one. If a warning is drawn with a triangle to warn to the risk of injury to persons, the risk of possible property damage may also be caused at the same time.

NOTE: During installation / maintenance of the platform, the safety functions are temporarily suspended. Therefore, all necessary precautions must be taken to avoid personal injury and / or damage to the product.



INFORMATION FOR LIFTING PLATFORM OWNER



The lifting platform owner must ensure that the lifting platform is used only for its intended purpose (transportation of passengers with impaired mobility, as well as passengers in wheelchairs, with or without a companion). If the lifting platform is used not according to its purpose, it may result in dangerous situations with the likelihood of injuries or damage to the lifting platform.

Only suitable and preventative maintenance performed by the competent service personnel in accordance with the technical instructions provided by Lifting Italia S.r.l., can provide safe functioning of the lifting platform.

The lifting platform owner must operate the lifting platform in accordance with safe operating conditions. For this, the lifting platform owner must use the maintenance service.

The lifting platform maintenance must be performed in accordance with the Maintenance manual of the vertical lifting platform, and the national legislation of the country in which the lifting platform is operated.

It is necessary to ensure that the periodic maintenance of the lifting platform is performed at least every three months after the lifting platform is put into operation.

The lifting platform owner must discontinue the operation of the lifting platform in the event of a dangerous situation (e.g. in case of strange noises or interrupted ride, etc.).

In case of lifting platform failures, in particular, the failures that affect the safety of passengers, the operation of the lifting platform is prohibited. The lifting platform owner must ensure that in case of failures the lifting platform is disconnected and passengers cannot use it.

The lifting platform owner must inform the lifting platform maintenance company:

- immediately, upon noticing any incorrect operation of the lifting platform, failure or abnormal change in its immediate environment;
- immediately, about the termination of operation of the lifting platform in the event of a dangerous situation;
- after intervention of any authorized and trained person (s) of the rescue service;
- before any modification relating to the use of the lifting platform, and (or) its environment;
- before any sanctioned third-party verification or work, other than the ongoing maintenance of the lifting platform;
- prior to long-term termination of operation of the lifting platform;
- before returning the lifting platform to service after a long period of inactivity.

The lifting platform owner must ensure the availability of the maintenance service name and telephone number for the lifting platform passenger at all times. The number must be permanently affixed and clearly visible.

The lifting platform owner must ensure that the keys to the machine cabinet, stop-landing doors are always available in the building and for the maintenance service to authorised persons.

The lifting platform owner must take care that the maintenance service, participating in the rescue of passengers, under any circumstances can safely enter the building and have access to the lifting platform.

The lifting platform owner must provide the competent staff of the maintenance service the safe and free access to the operational areas and notify the maintenance service of any hazards or changes in the entrances to the operational and (or) entrance walkways.

SAFETY MARKINGS AND OTHER MARKINGS:

Checking whether the maintenance service name and phone number are indicated on the platform.

- Lifting Italia S.r.l. declines all responsibility for any direct or indirect damage caused by operational errors, lack of professional maintenance and any other use not described in this manual.
- Lifting Italia S.r.l. declines all responsibility even in the event that modifications of any kind should be made to the machine without the prior written consent of Lifting Italia S.r.l.



1. PRODUCT DESCRIPTION

EasyPlat is a low-rise platform lift with belt drive, designed for home accessibility, with a maximum stroke of 3 m.

The landing on the floors (P1 and P2) are closed by gates integrated respectively in the platform and in the sling / engine block.
EasyPlat offers extremely easy installation thanks to the pre-assembled blocks and is suitable for installation both inside and outside of buildings.

2006/42 / EC Machinery Directive;

- ① Platform
- ② Floor with integrated ramp
- ③ Emergency door lock opening
- ④ Platform control panel
- ⑤ Platform call button
- ⑥ Machinery cabinet
- ⑦ Lifting platform guide rails
- ⑧ Electric board

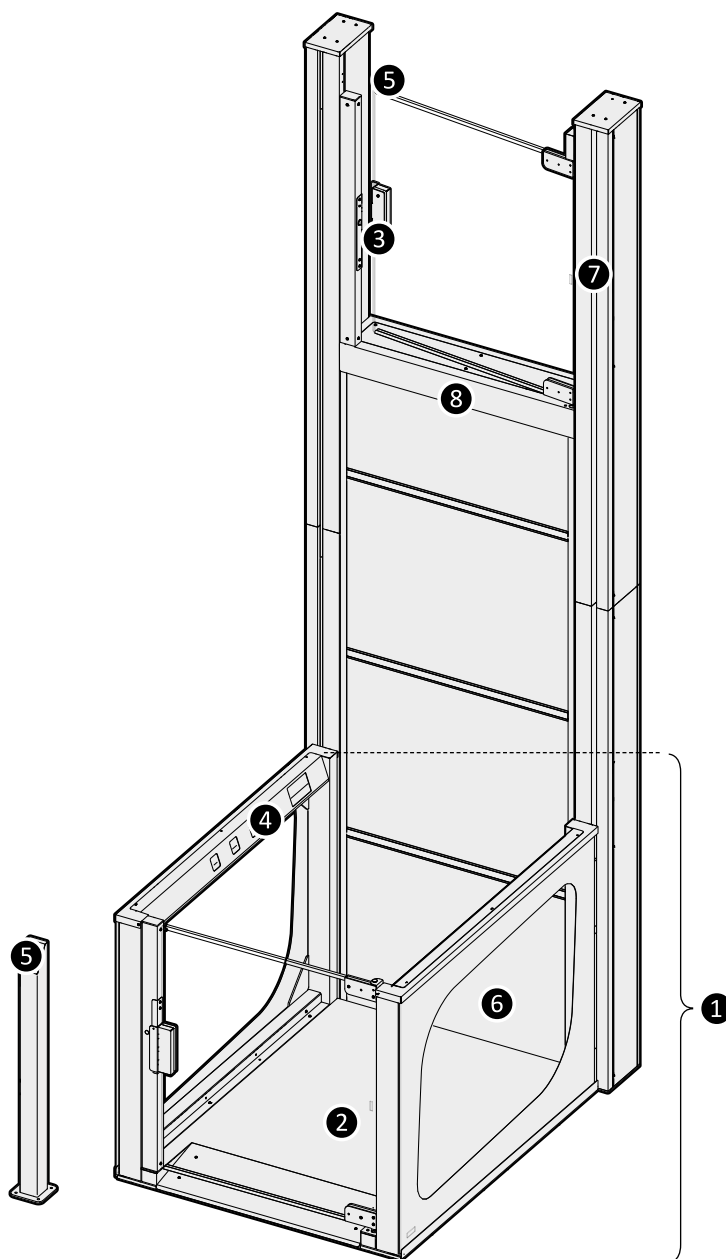

The lifting platform is designed for transportation of passengers with impaired mobility, as well as passengers in wheelchairs, with or without a companion, for a maximum travel of 3m. **The lifting platform owner must ensure that the lifting platform is used only for the intended purpose.**



2. LIFT EMPLOYMENT AND OPERATION

2.1. NORMAL OPERATION MODE

Under normal operating conditions, the lifting platform can perform platform ascent and descent operations only following the constant pressure of a manoeuvring button located in the platform control panel (operator-presence control).

Landing operation: the platform is called to a floor by constant pressure the button. Therefore, the commands are effected from landing operation panels (paragraph 1.1.1) and platform operation panels (paragraph 1.1.2).

INFORMATION



In case of remote control device, all platform switches are actioned just by a remote control device.

2.2. LANDING OPERATION PANELS

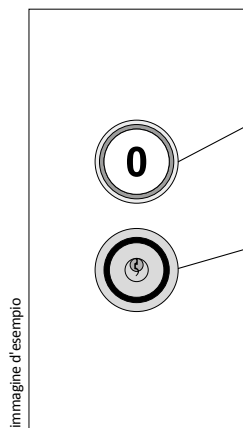

The landing operation panels are mainly equipped with:

Platform PRESENCE LIGHT

It is compulsory when the platform doors are manual and windowless, to indicate that the platform is present at the floor. The signal can be replaced by a display.

KEY SWITCH (optional)

The key switch enables or disables the lift call. Usually two-position-two-extraction key switches are employed, but also other types of keys can be supplied upon request.

INFORMATION



SWITCH FROM FLOOR COMMAND

Push the button to call the platform at the floor, in case of key switch, verify the key is on enabled command position.



SWITCH FROM FLOOR COMMAND ON PLATFORM

Once on the platform, it is possible to action the switch keep on pushing the button up to the desired floor.



2.3. PLATFORM OPERATION PANEL



immagine d'esempio

The platform operation panel is equipped with:

1. ALARM BUTTON

To press to activate the alarm.

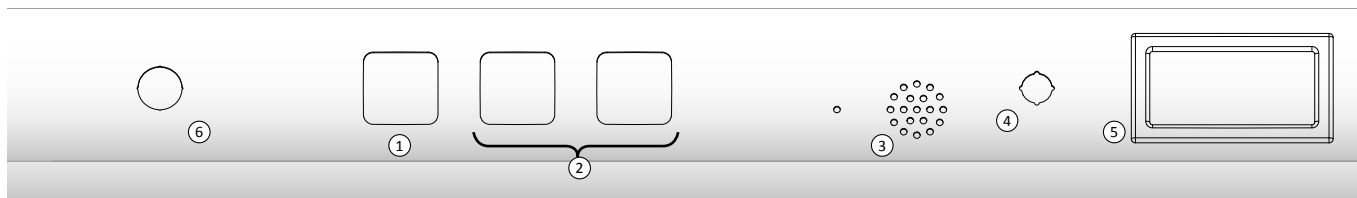
2. Platform OPERATION BUTTONS

They are equipped with a light signal that indicates the position of the platform.

3. BIDIRECTIONAL COMMUNICATION DEVICE (optional)

If the constant monitoring of the platform is guaranteed, it will be possible to replace the two way voice communication device (remote assistance) with an intercom system. "Constant monitoring of the platform" means that, during the periods of use of the lifting platform, the owner ensures that a person, trained and enabled to perform the emergency lowering operation, is always available to attend the intercom connected to the inside of the platform.

4. STOP BUTTON ON THE PLATFORM

Push type and red colour, it interrupts any operation when it is pressed and remains locked until it is twisted and released.

5. PLATFORM PLATE

Indicates platform number, load capacity, passengers, voltage and power.

6. PLATFORM OVERLOAD SIGNALING

If on, it indicates that the nominal load of the platform has been exceeded. The platform returns to normal operation only after the overload has been removed from the platform: at this stage the signal in the platform goes out.

On the landing gate opening, the **platform lighting turns on** automatically and remains on as long as the gate remains open or all through the ongoing operation. The platform lighting is on temporarily: in the absence of the lift being used, the platform lighting turns off within 5 seconds after the landing gate is closed.

2.4. OPERATION FROM LANDING OPERATION PANELS

The backlight of the lift call button indicates that the platform is present at the floor, the door is unlocked and can be opened (the automatic door opens by itself).

If no light signal is present, a platform call can be made from the landing panel. Press the button; in the presence of a key switch, make sure that the key enables the command. The central part of the button will be backlit to indicate that the platform is moving: each of the landing operation panels will display the same signal. Upon the platform arrival, the "present" light will turn on and the "busy" light will turn off after 5 seconds.

It is not possible to command the lift while the "busy" signal is on.

With the platform present at the floor and the door unlocked, it will be possible to enter the platform (the automatic doors open by themselves). On the door opening, the "busy" signal will be activated for all the floors, to indicate the presence of an open door. This signal will turn off 5 seconds after the door closure.

2.5. OPERATION FROM CAR OPERATING PANEL (COP)

In case of MANUAL LANDING DOORS:

Upon the door opening, the "busy" landing signal and the platform lighting will be activated immediately.

In case of AUTOMATIC LANDING DOORS:

Upon pressing the LOP button the "busy" landing signal and the platform lighting will be activated immediately.

As soon as the landing and platform doors have been closed, the lift can be commanded again, by pressing and holding the required button; on leaving the floor, the "present" signal on the related landing panel will turn off.

2.6. PRESSURE SENSITIVE PROTECTIVE DEVICE - PLATFORM SAFETY UNDERPAN



CAUTION

DANGER OF CRUSHING:

ALWAYS MAKE SURE THE AREA BELOW THE PLATFORM IS CLEAR OF OBSTACLES!

INFORMATION



The machine is equipped with a **safety underpan** that can detect any obstacles below the platform during descent motion. In the event of triggering of this device, the descent motion of the machine is immediately interrupted; lifting motion is allowed in order to remove the obstacle or to land at the top access.



2.7. ENABLE / DISABLE THE PLATFORM

1. At start-up both standard and remote commands are disabled. Enable them using the remote controls or the key-switch on the top floor.

NOTE: the key-switch has higher priority on the remote commands: if it disables the platform the remote will not work. To use the enable/disable commands on the remote, the key-switch must be left in ON position.

2. After a successful enable command, the platform lights and buzzer will blink twice.
3. After a successful disable command, the platform lights and buzzer will blink once.
4. The platform commands can be disabled only when the cabin is at one of the limit positions.
5. Even if the commands are disabled it is always possible to unlock the door using the COPs pushbuttons.

2.8. REMOTE COMMANDS

Led



1. DOWN
2. UP
3. ENABLE
4. DISABLE

INFORMATION



the LED does not blink after pressing any pushbutton replace the remote battery.



2.9. ACOUSTIC SIGNALS FOR THE USER

SUONO	SIGNIFICATO
CONTINUOUS	The safe bottom has been engaged during a downward movement.
CONTINUOUS BEEPS	Overload.
2 BEEPS	The user is trying to move the platform but one of the doors is not completely closed.
3 BEEPS	The user is trying to move the platform but one of the emergency stops is engaged.

2.10. POWER OUTAGE EMERGENCY OPERATION

The elevator platform is equipped with an emergency circuit that, by means of an uninterruptible power supply (UPS), keeps the system powered in case of electrical power failure. In this situation:

- **all the operation buttons** activate **only the descent** to the lowest stop (whichever button is pressed);
- as soon as the lowest floor has been reached, the lift stops and cannot be used until the normal power supply is back.

2.11. EMERGENCY STOP

Should any emergency situation occur, by pressing the STOP button the platform will stop and the lift will be blocked; this operation also activates all the “busy” signals on landing panels.

The user can press the Alarm button to ask for assistance.

To reactivate the normal operation mode, it is sufficient to rotate it the direction indicated by the arrow (as soon as the possible, the reasons for the emergency situation be identified).

The instructions to be followed are indicated on the adhesive plate beside the COP.

2.12. LIFT OVERLOAD

The platform lift is designed to bear the maximum nominal load in relation to the platform free surface. Exceeding this value may lead to serious risks for the users and operators' safety and cause damage.

To prevent such situations, an overload device is provided on the system. In case of intervention, both light and acoustic signals are activated on the COP. Any platform operation is impossible until the overload has been removed.

The overload removal reactivates the normal operation automatically.

	 CAUTION	
	<u>The nominal load indicated on the car plate must always be respected.</u>	

2.13. LIFT FAILURE

Should the lift not respond to further user's commands after a normal stop, check if the landing door is closed correctly and no “busy” signal on the LOP's (or emergency signal inside the platform) is present. Notwithstanding the tests, if the lift does not respond to the commands, especially if the platform is misaligned with respect to the floor level, then the maintenance company is to be notified, as a technical intervention from a trained engineer will be required.



2.14. TELEPHONE ASSISTANCE (recommended option)

- ☐ ☐ ☐ To activate the communication on the platform, press the "bell" button for some seconds until the assistance center answers the call.
- ☐ ☐ ☐ ☐ ☐ When the call is answered the lift user will be able to explain the problem.
- ☐ ☐ ☐ ☐ ☐
- ☐ ☐ ☐

2.15. SWITCHING OFF THE LIFT

Follow the points below:

- remove the threshold of the upper floor,
- turn off the uninterruptible power supply (UPS) e
- use the QF2 switch to turn off the machine.



CAUTION

Before switching off the lift, make sure that the car is stationary at the lowest floor.

2.16. MAINTENANCE AND CLEANING

The user must verify the following conditions with the recommended frequency.

Daily operations.

- COP and LOP buttons integrity and function;
- absence of obstacles which may obstruct correct door closure and locking; · effective door locking at the stops where the platform is not present;
- control board key-lock.

Weekly operations.

- battery efficiency and emergency descent in case of power outage. For this purpose, generate a power outage using the main power supply switch: **do not use the driving force main switch (located after the main power supply switch), otherwise the batteries will be disabled as well.**

Check the platform lighting, platform descent using normal operation buttons and platform emergency alarm .

Upon the power reactivation, the lift will be ready for use.

For ordinary cleaning (platform, doors, buttons etc.) do not use sponges or abrasive cleaners, perfumed solvents or alcohol, just a soft damp cloth and neutral soap are necessary.

In case of satinised surfaces, always follow the direction of the finish.





NOTICE



Pay attention to water inlet ingress the machine.

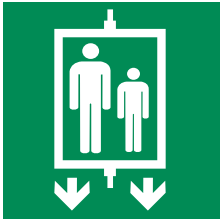

3. SAFETY SIMBOLS

LABELS (PICTOGRAMS), TEXT WARNINGS	
PICTOGRAMS	TEXT (WITH EXPLANATION)
	<p>WARNING ELECTRICITY</p> <p>When the electrical work is carried out during the maintenance of the lifting platform, the lifting platform powering disconnection device must be turned off.</p>
	<p>CRUSHING OF BODY HAZARD</p> <p>The label must be attached: the machinery cabinet near the emergency devices, and the enclosure pit must have the label of reduced spaces of the bottom hole in the enclosure pit. This label warns of the danger of crushing — the platform mechanical stop must be set to the operating position before entering the enclosure pit.</p>
	<p>EMERGENCY DESCENT</p> <p>Passenger release instructions are attached to inside of the machine cabinet cover. Passenger release instructions contain information indicating how to release the passengers in a safe and proper manner.</p>
	<p>INTERNATIONAL SYMBOL OF ACCESSIBILITY</p> <p>If the lifting platforms are used in public buildings, each stop-landing must have an international symbol of access. The character height should be at least 50 mm. This symbol indicates that the lifting platform is designed for use by disabled persons.</p>