

Line® - Lumiere

Hinged Landing Doors

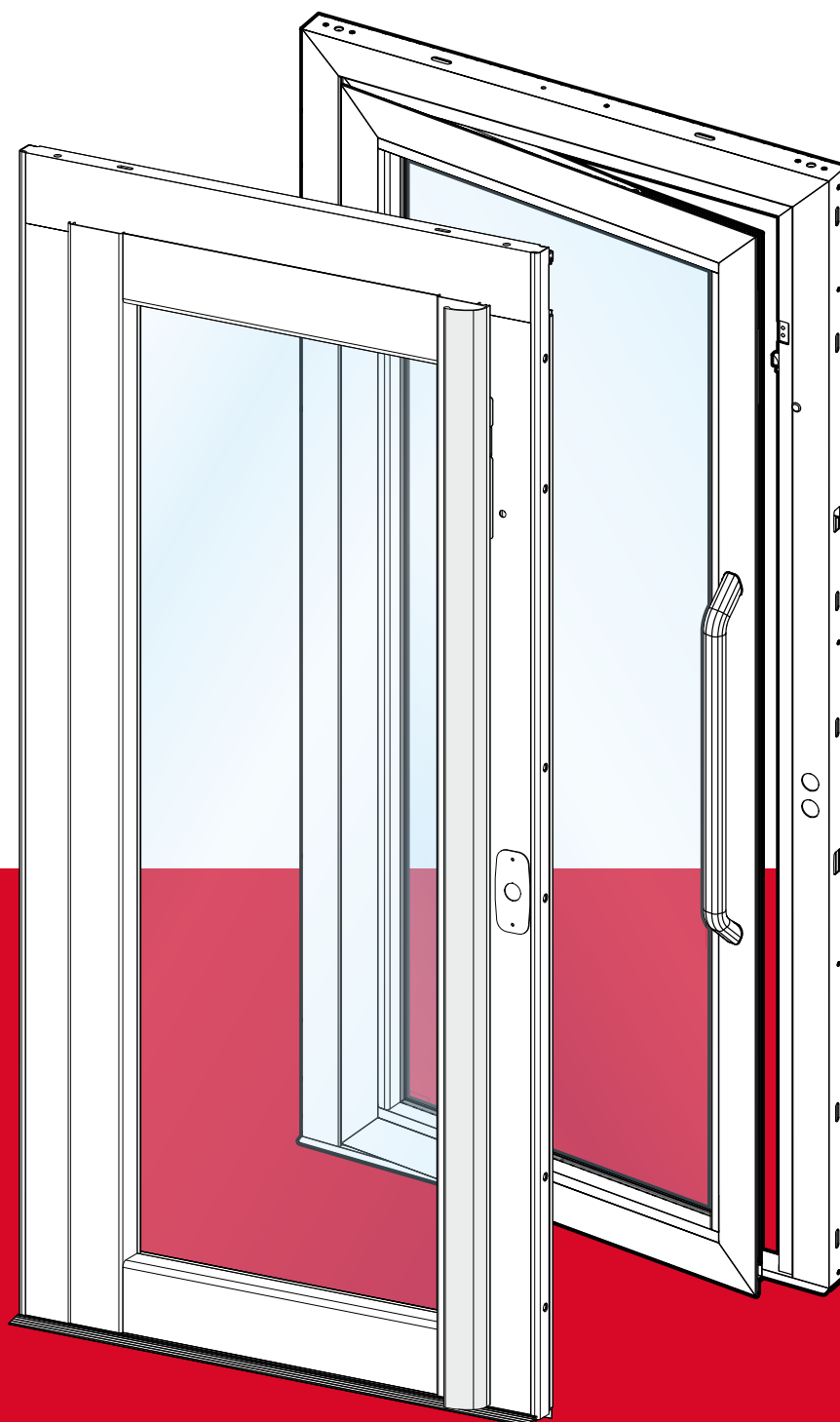

Sample image

DOOR CLOSER
INSTALLATION INSTRUCTIONS

Line® Door

1. Oubau door closer installation

1.01. In case of CAN-LIFT lock

- ① Open the door leaf.
- ② Remove the casing of the transom.
- ③ Position the door closer.
- ④ Secure the door closer with the screws provided.
- ⑤ Install the door closer lever.

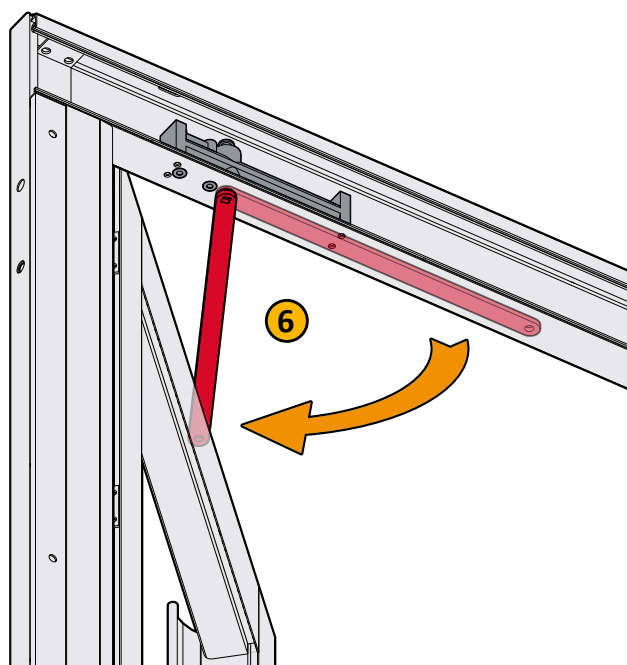
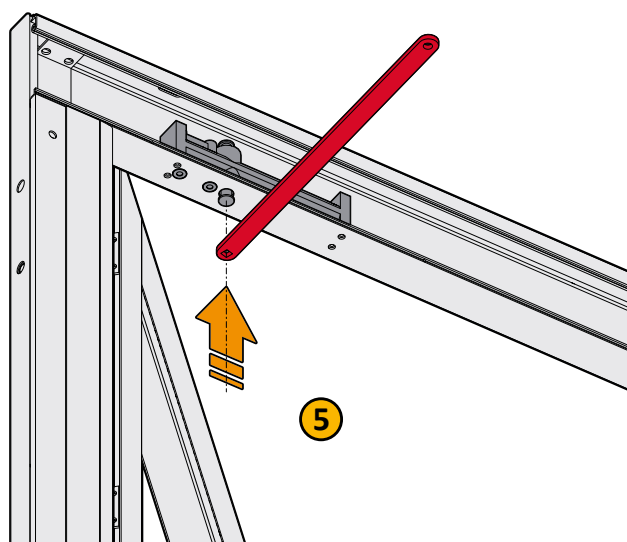
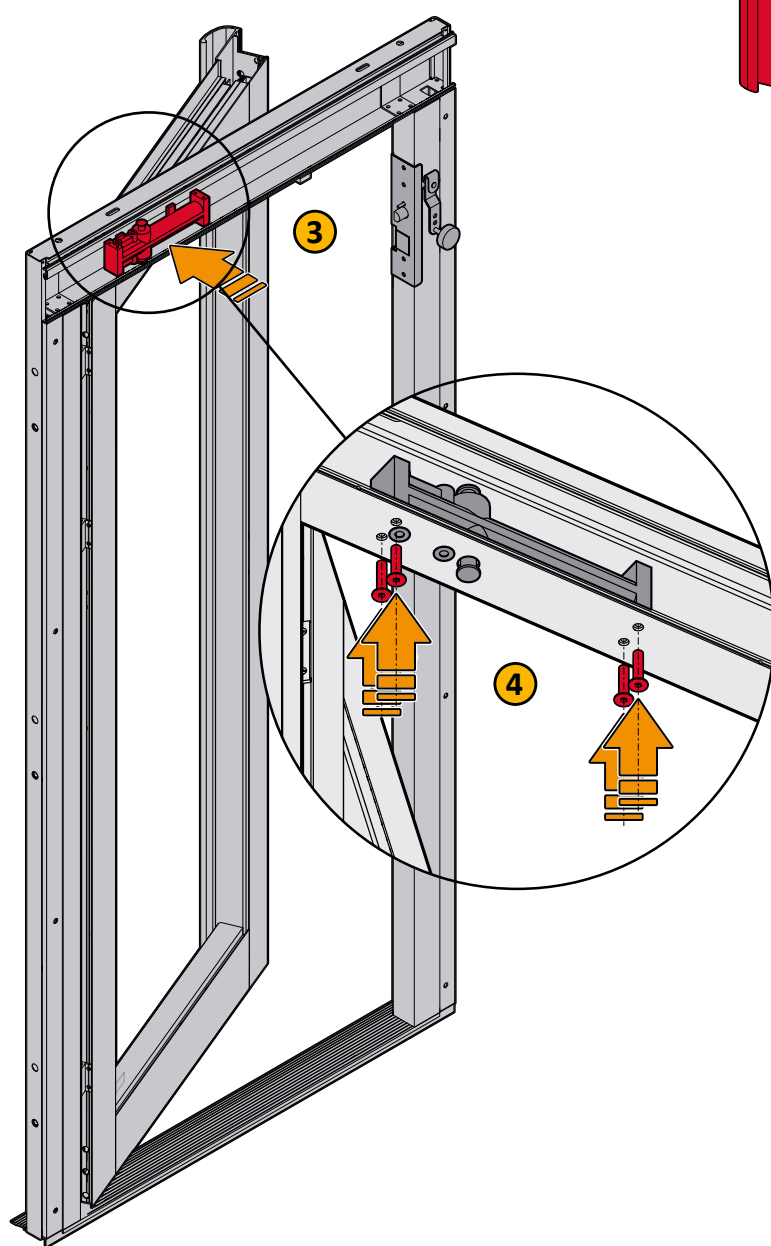
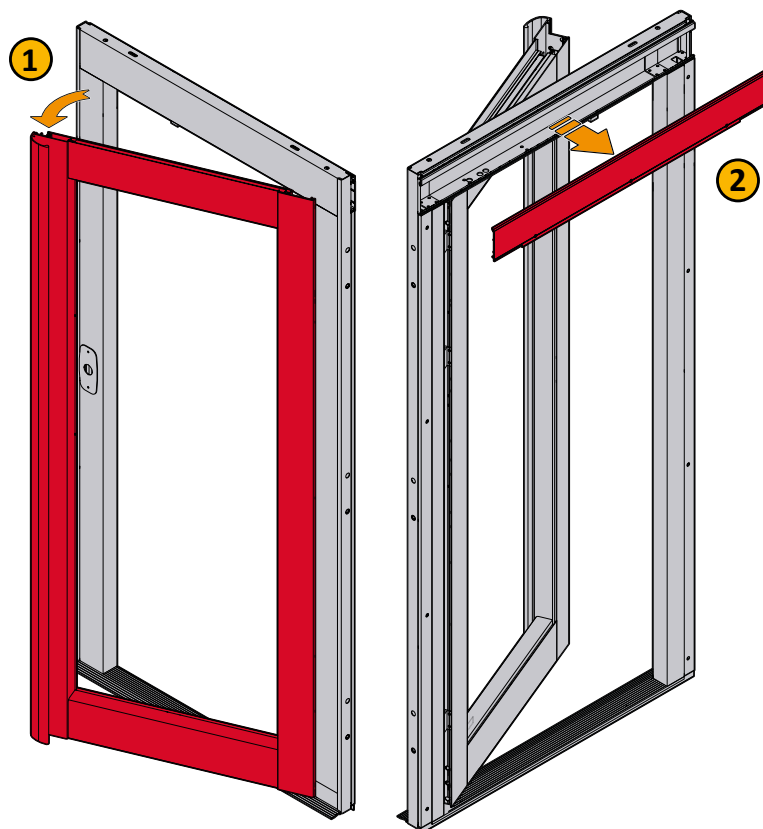

- ⑥ Rotate the door closer lever.

- 7 Insert the slider into the door leaf guide.

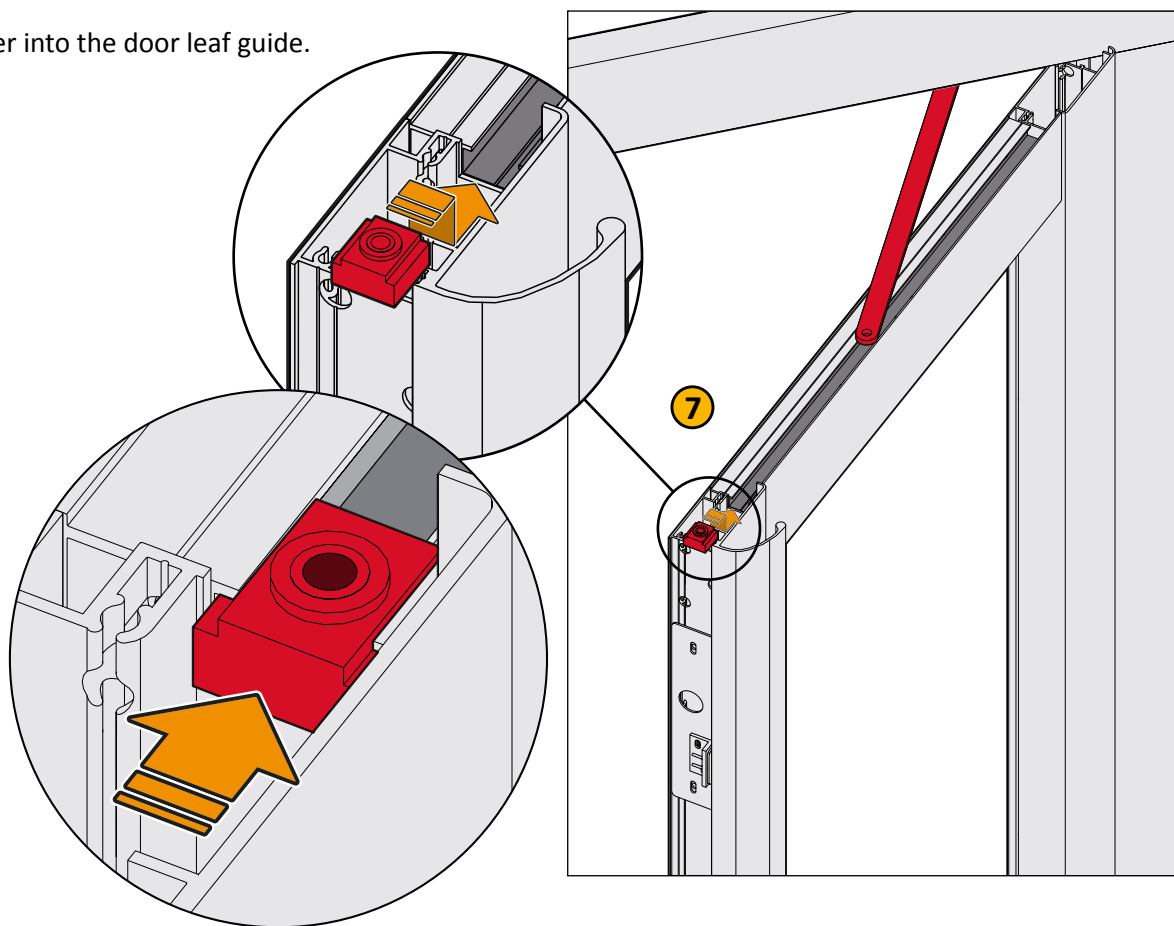

- 8 Secure the arm to the slider with the supplied screw.

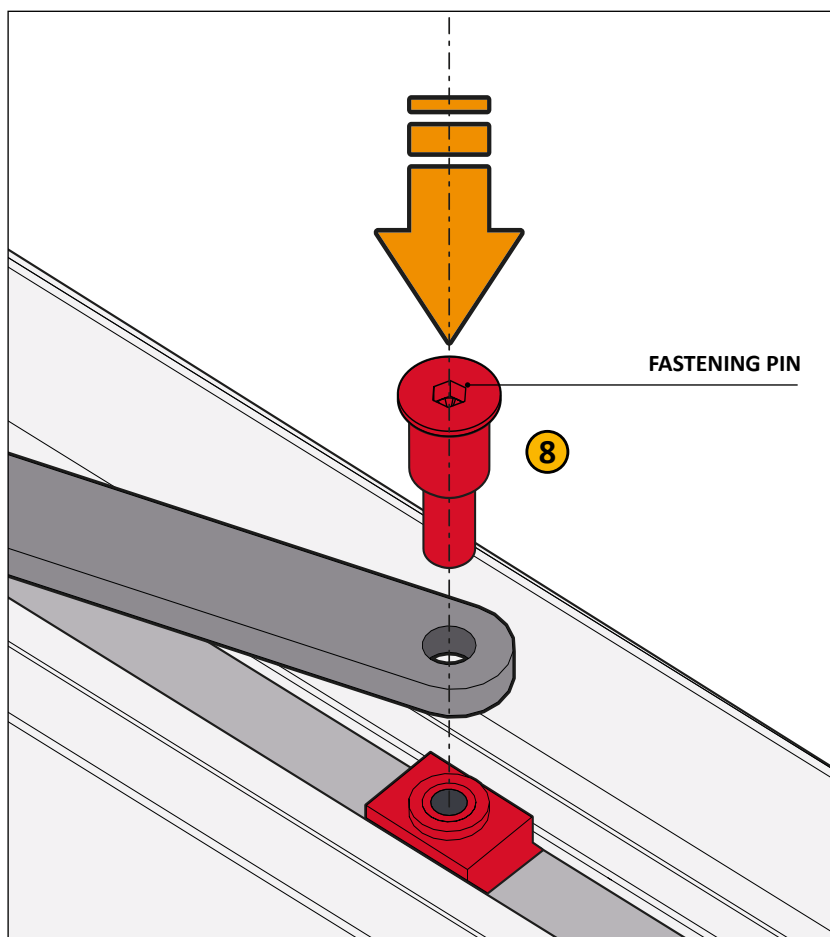

1.02. In caso di serratura GERVALL

- ❶ Open the door leaf.
- ❷ Remove the casing of the transom.
- ❸ Position the door closer.
- ❹ Secure the door closer with the screws provided.
- ❺ Install the door closer lever.

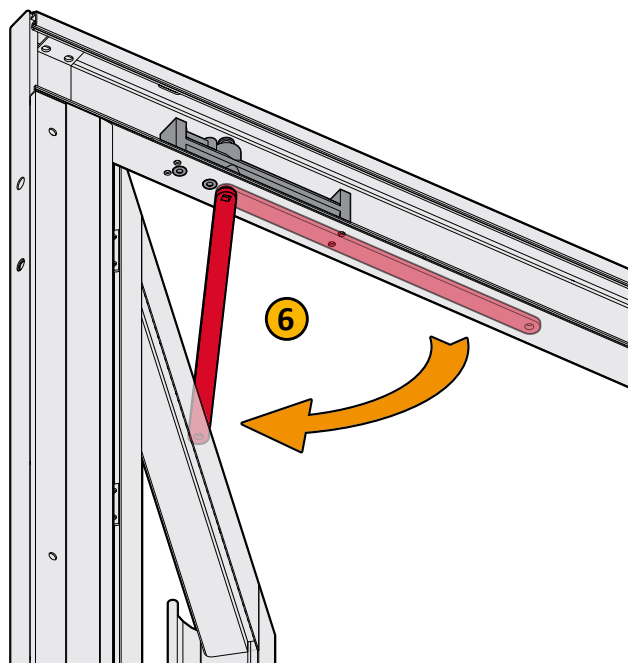
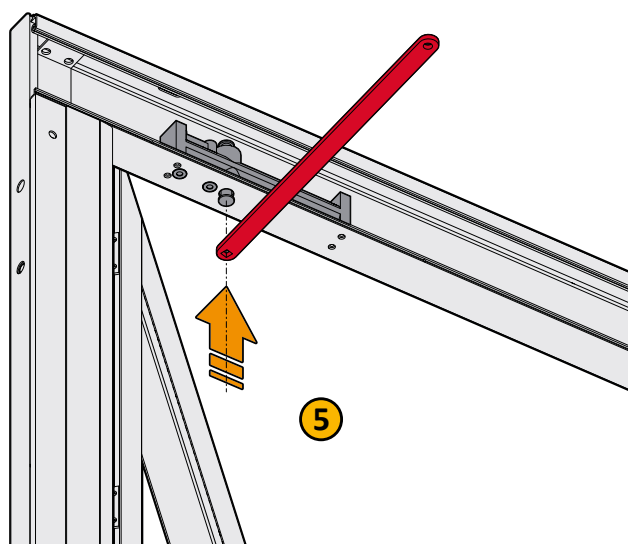
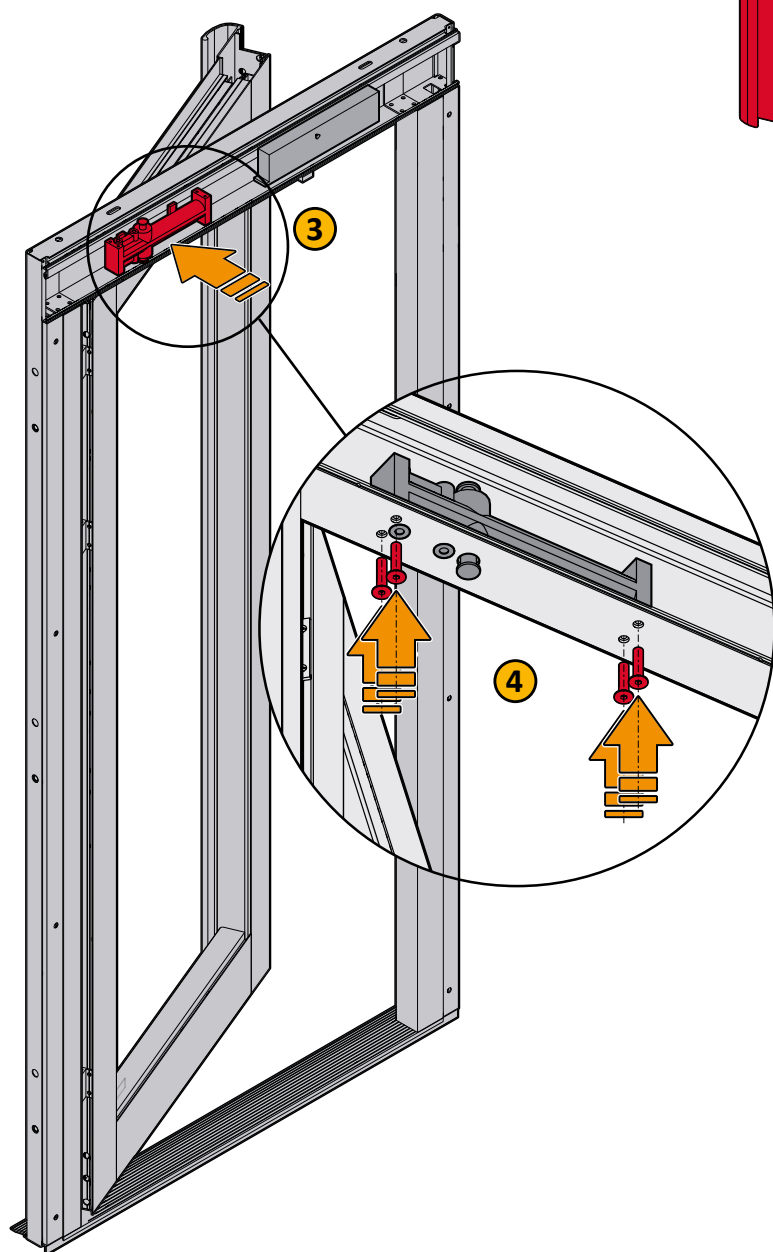
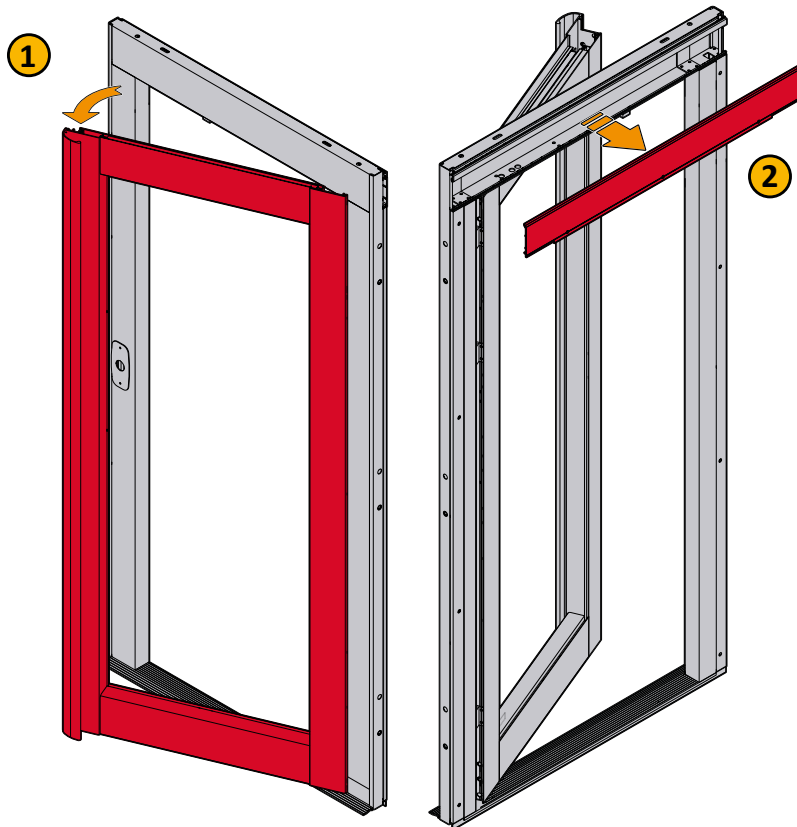

- ❻ Rotate the door closer lever.

- 7 Insert the slider into the door leaf guide.

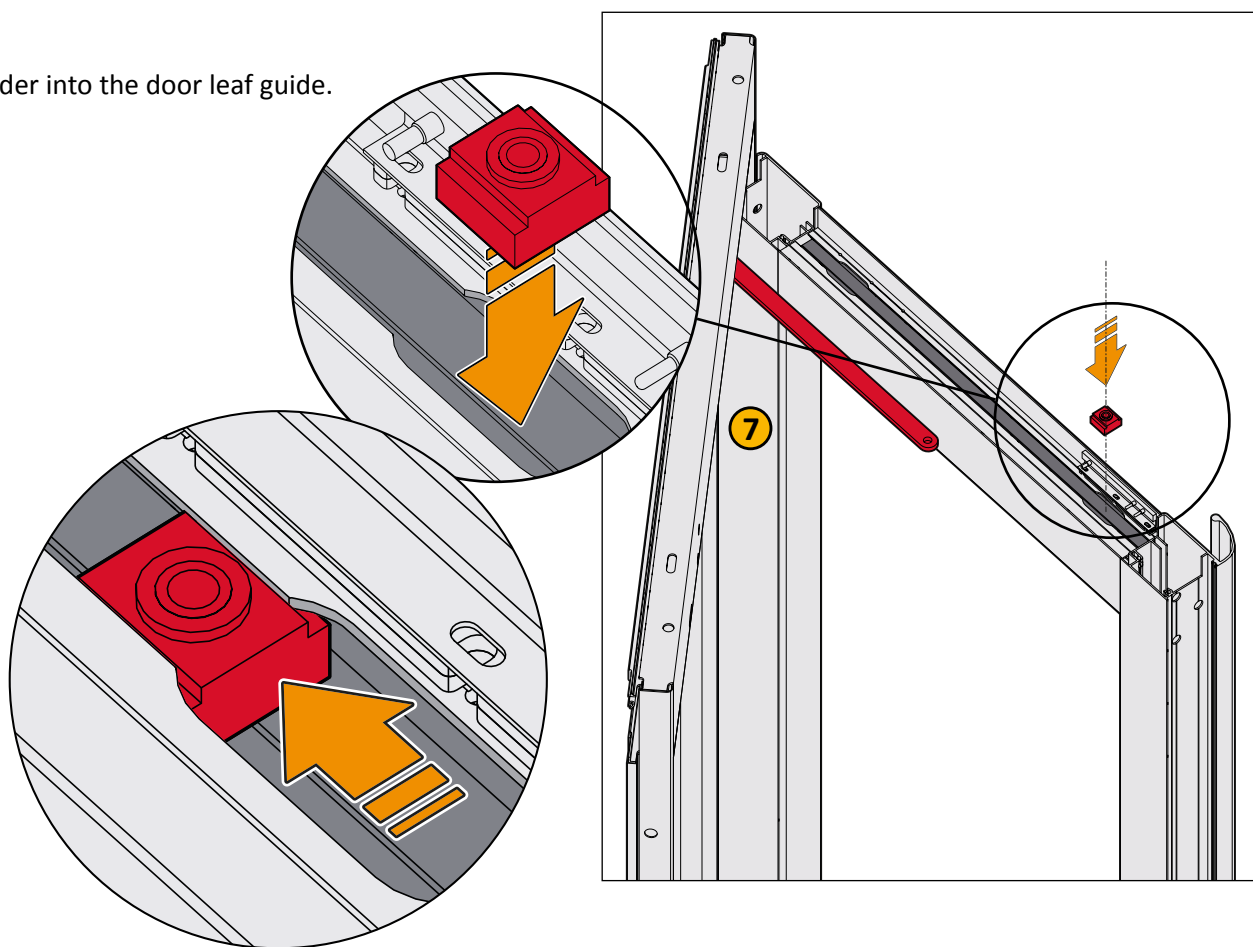

- 8 Secure the arm to the slider with the supplied screw.

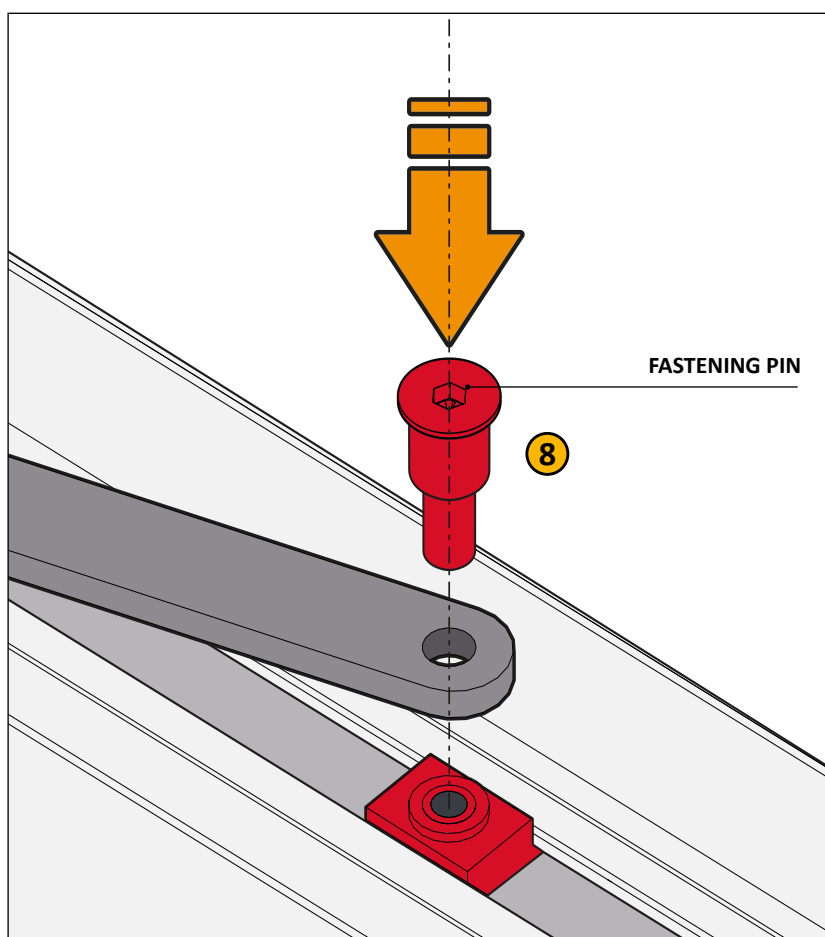

Lumiere® Door

2. Installazione chiudiporta Oubau

- ❶ Open the door leaf.
- ❷ Remove the casing of the transom.
- ❸ Position the door closer in the transom, inserting the appropriate plate/shim (A).
- ❹ Secure the door closer with the screws provided.
- ❺ Install the door closer lever.

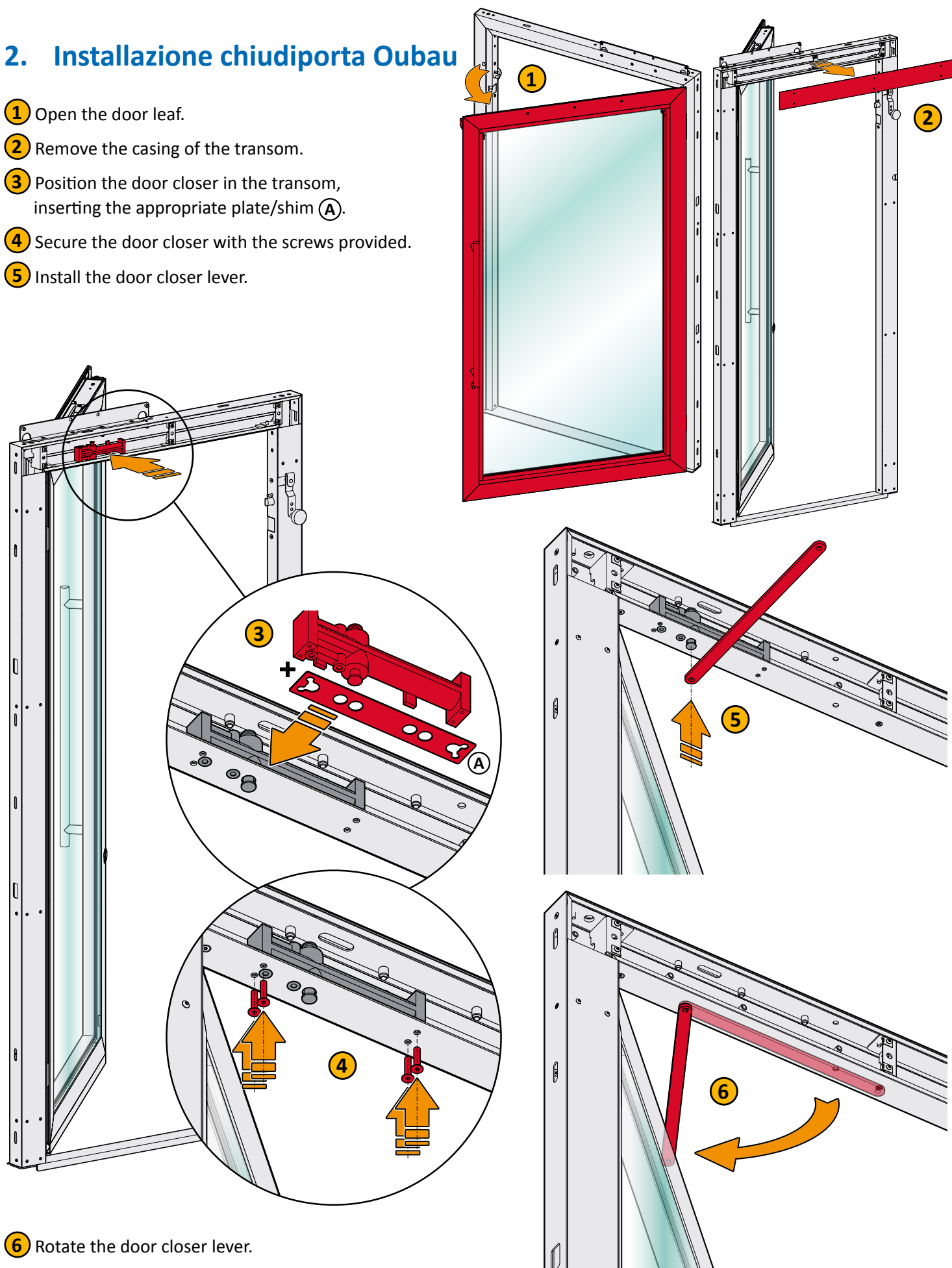

- 7** Insert the rail into the door leaf housing and secure it with the screws provided.

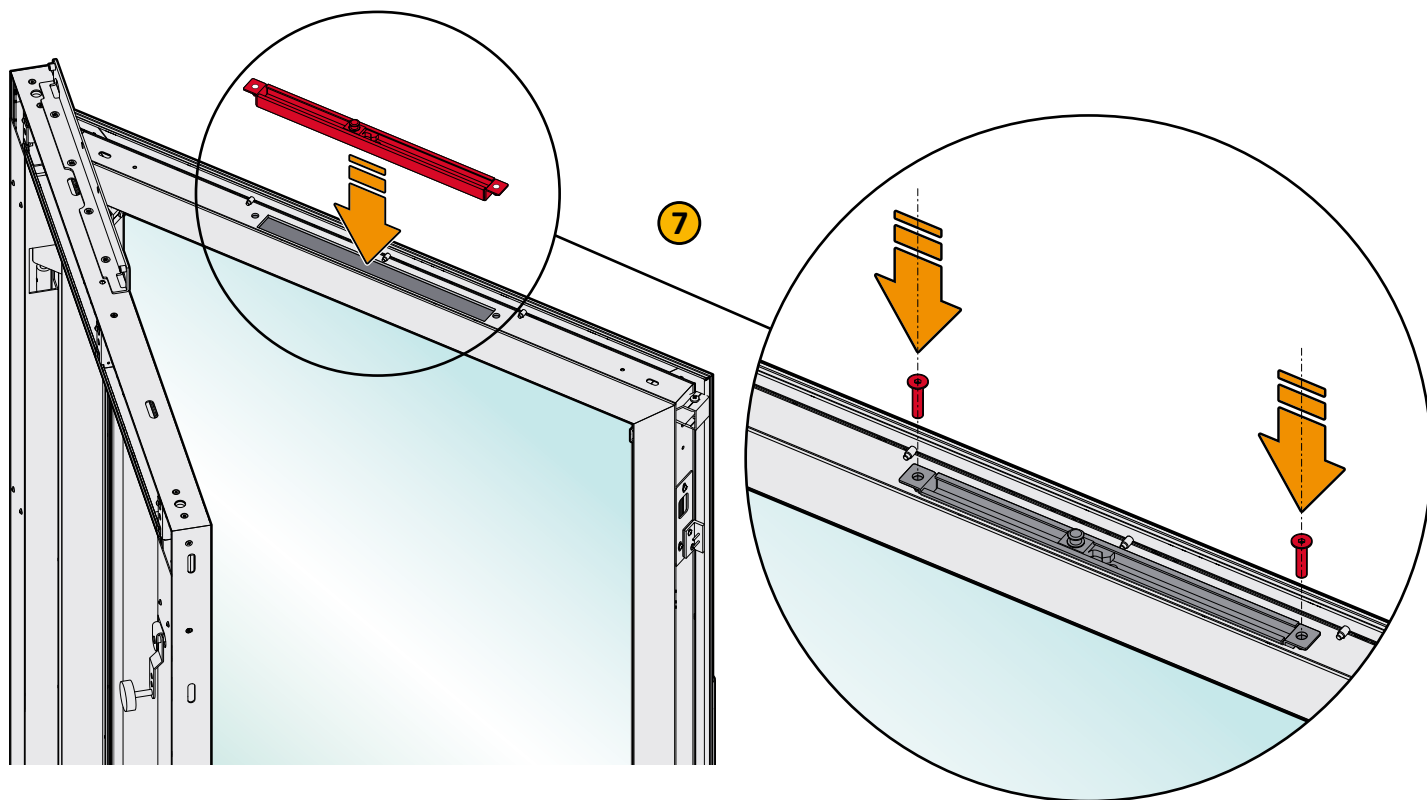

- 8** Attach the arm to the slider with the supplied screw, making sure to insert the ring bush.

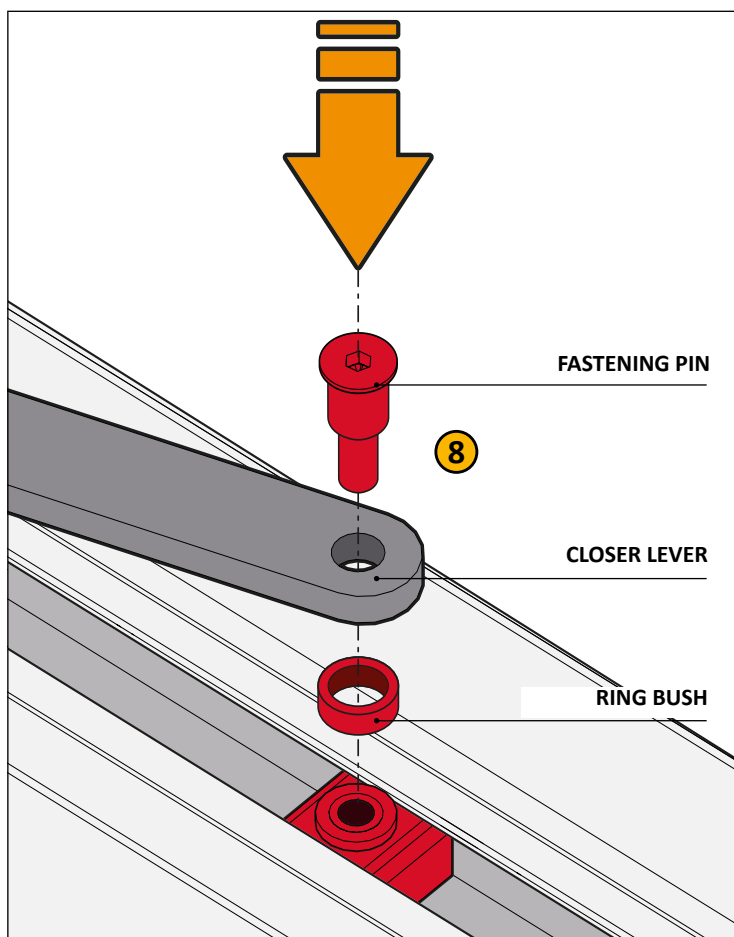
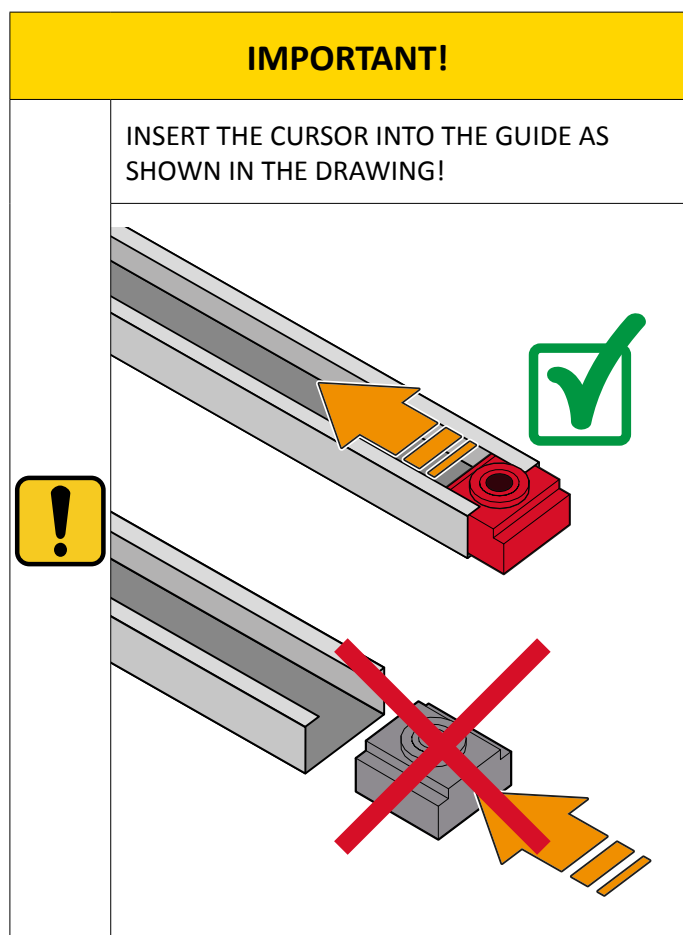

3. Final adjustments

3.01. Manual door closer



ADJUSTING THE CLOSING SPEED AND THE FORCE OF THE FINAL STROKE, which are usually performed using special screws, **ARE IMPORTANT**, both to adapt perfectly the action of the door-closer to the weight of the door on which it is applied, and to ensure effective operation in all seasons. The viscosity of the internal oil actually changes in relation to the external temperature. **THE ACTION OF THE DOOR-CLOSER IS THEREFORE SUBJECT TO NATURAL SEASONAL VARIATIONS THAT MAY REQUIRE MINOR PERIODIC ADJUSTMENTS**, in order to maintain the effectiveness of the mechanism. The door-closer has 2 different adjustments: the closing speed and the force of the end stroke that is used to overcome the lock latch resistance at the time of closing.

- Adjust the force of the end stroke and then the **Acceleration Speed** according to the weight of the door by rotating screw A no greater than $30^{\circ} \div 45^{\circ}$.
- Adjust and periodically check the **Closing Speed** by rotating screw B no greater than $30^{\circ} \div 45^{\circ}$.

